

WR CURB INLET (SINGLE)

GENERAL NOTES:

1. CONCRETE SHALL BE CLASS B. CAST-IN-PLACE CONCRETE WALLS SHALL BE FORMED ON BOTH SIDES. STEPS SHALL BE PROVIDED WHEN INLET DIMENSION "H" EXCEEDS 3'-6" AND SHALL BE IN ACCORDANCE WITH AASHTO M 199. ALL INLETS SHALL BE CONSTRUCTED ON GRADE
2. PER DESIGN PROFILE.
3. ALL INLETS SHOULD BE STAMPED SEE DETAIL U-C05 PHASE II LID.

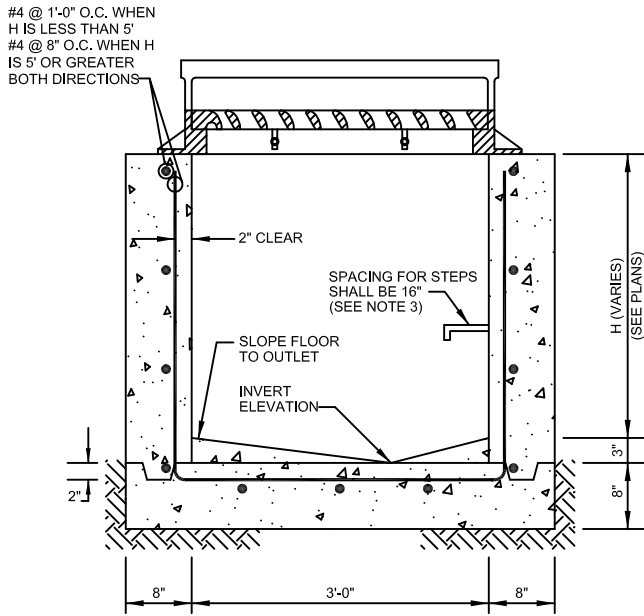

WR CURB INLET (SINGLE)

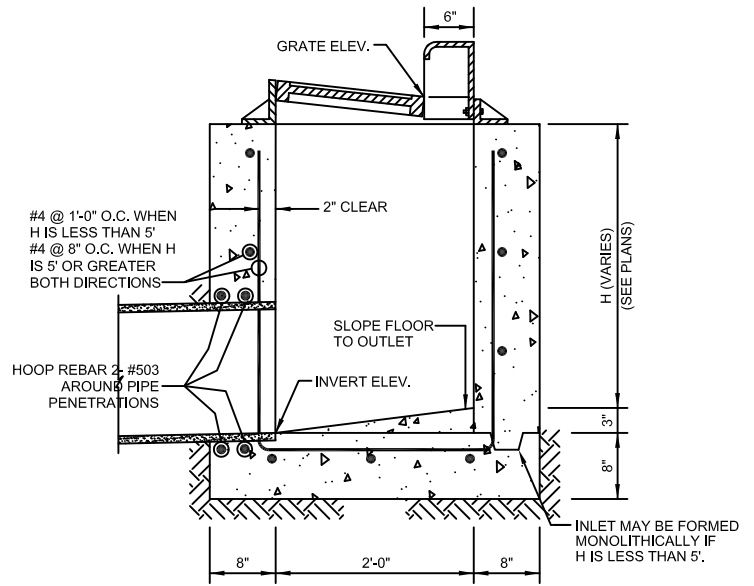

WR CURB INLET (SINGLE)