

NOTES:
 CROSSWALK MARKINGS TO BE PLACED OUTSIDE WHEEL PATHS.
 CROSSWALK SHALL BE ALIGNED WITH HANDICAP RAMPS.

PAVEMENT MARKING MATERIAL ON ASPHALT AND CONCRETE SHALL BE 3M-270ES (WHITE) AND 3M-271ES (YELLOW). PAVEMENT ADHESIVE FOR CONCRETE SHALL BE 3M-P50.

CROSSWALK, STOP BAR, SYMBOLS AND LEGENDS MATERIAL SHALL BE 3M-270ES ON BOTH ASPHALT AND CONCRETE PAVEMENT.

ALL REMOVALS SHALL BE BY GRINDING, SANDBLASTING OR CHEMICAL METHODS PROVIDED THAT THE PAVEMENT SURFACE SHALL NOT BE MATERIALLY DAMAGED. THE PAVEMENT MARKINGS SHALL BE REMOVED TO THE EXTENT THAT THEY SHALL NOT BE VISIBLE UNDER DAY OR NIGHT CONDITIONS. BLACK OUT PAINT MAY ONLY BE USED WHEN APPROVED BY THE PROJECT ENGINEER FOR SHORT TERMS, USUALLY LESS THAN 2 WEEKS.

ALL EXISTING VEHICLE DETECTORS SHALL BE INSPECTED AFTER THE MILLING OPERATION OR PRIOR TO THE OVERLAY. REPLACE ANY DISTURBED OR DISABLE DETECTOR AS NECESSARY.

DIMENSIONS ARE MEASURED FROM LIP OF GUTTER.

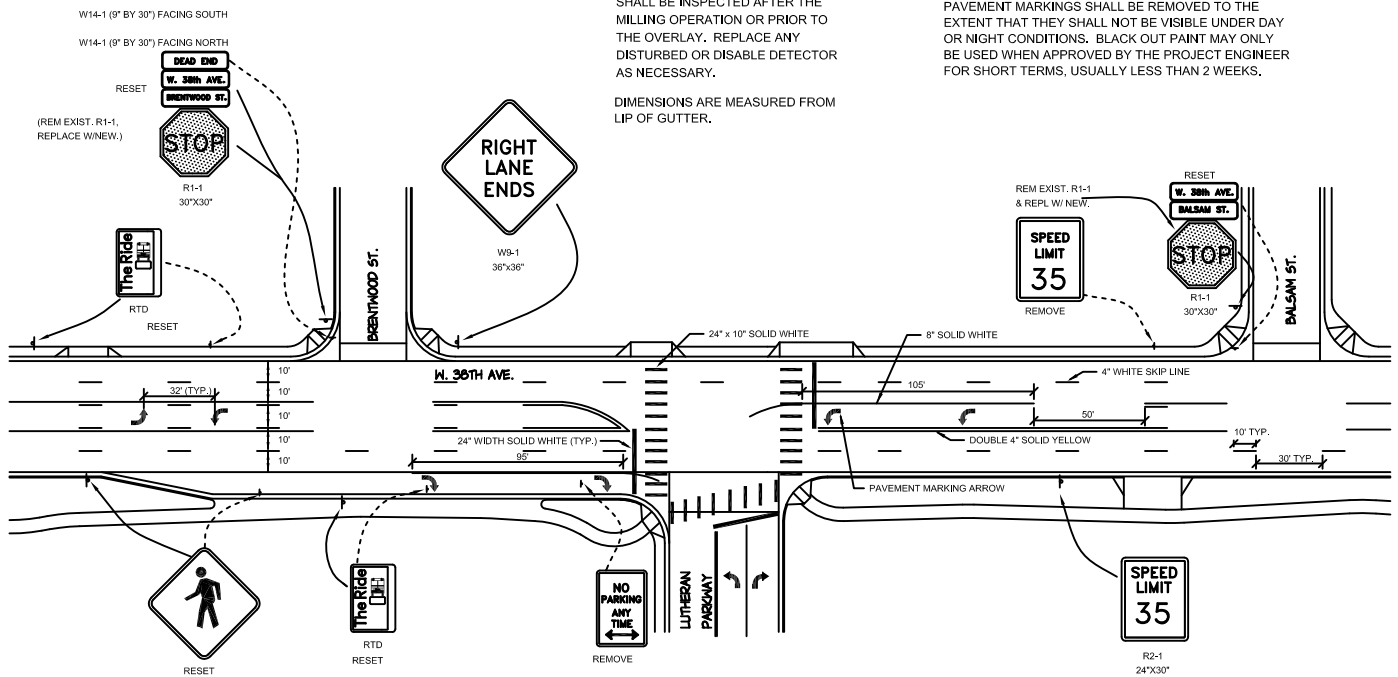

SAMPLE SIGNING AND STRIPING PLAN



CITY OF WHEAT RIDGE

DEPT. OF PUBLIC WORKS
 ENGINEERING DIVISION

APPROVED BY: SNN 06/07

T-A01 TYP SIGN - STRIP

SAMPLE SIGNING & STRIPING PLAN

DETAIL CODE

T